

Rebel Design

Cate Sword

Cate Sword Consulting + Design



What is Rebel Design?

- Using tools for things they weren't actually designed for
- Finding work arounds
- Working faster, smarter, more accurate

Topics

- Quick and easy way to get a super clean AutoCAD drawing
- Difficult and painful way to plot that AutoCAD background in Greyscale
- Workspace and Custom tools
- Key binding/Graphical snapping
- Fun Bonus Tips

Clean AutoCAD drawing

- Turn on/off the layers in AutoCAD
- Type WBLOCK
- Do not change the Base Point!
- Select what you want included
- Pick OK
- Don't save the original

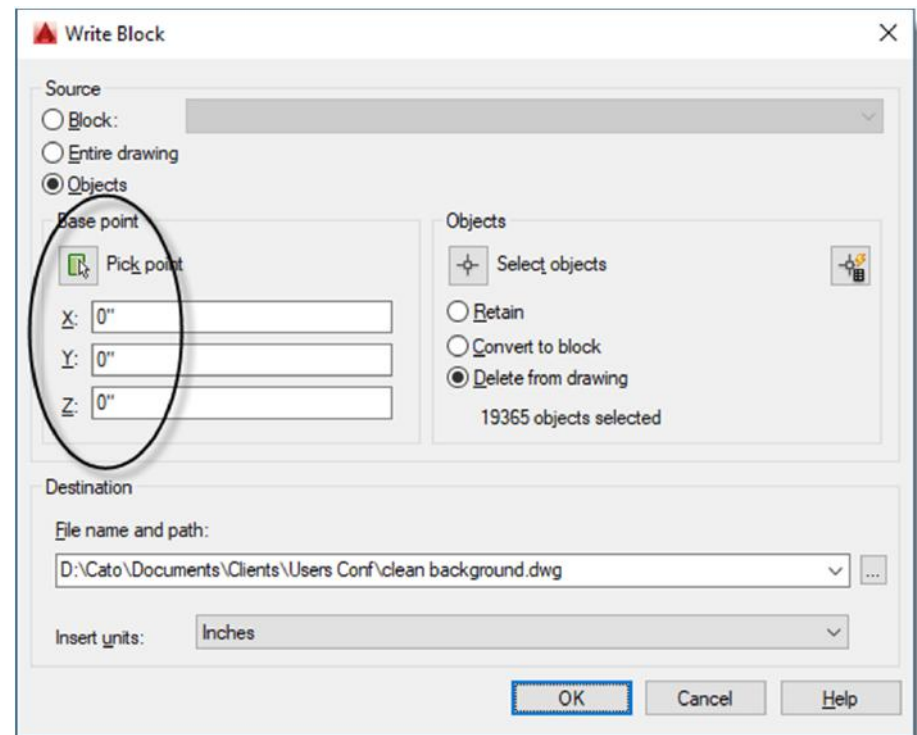

Light Shell when plotting

- Set the layer colors to Gray
- Make two viewports that are exactly the same except for visibility
- Set the Furniture viewport as black and white
- Leave the Shell viewport as color
- Place them exactly on each other
- Bonus tip: Turn the Revcloud on with the shell.

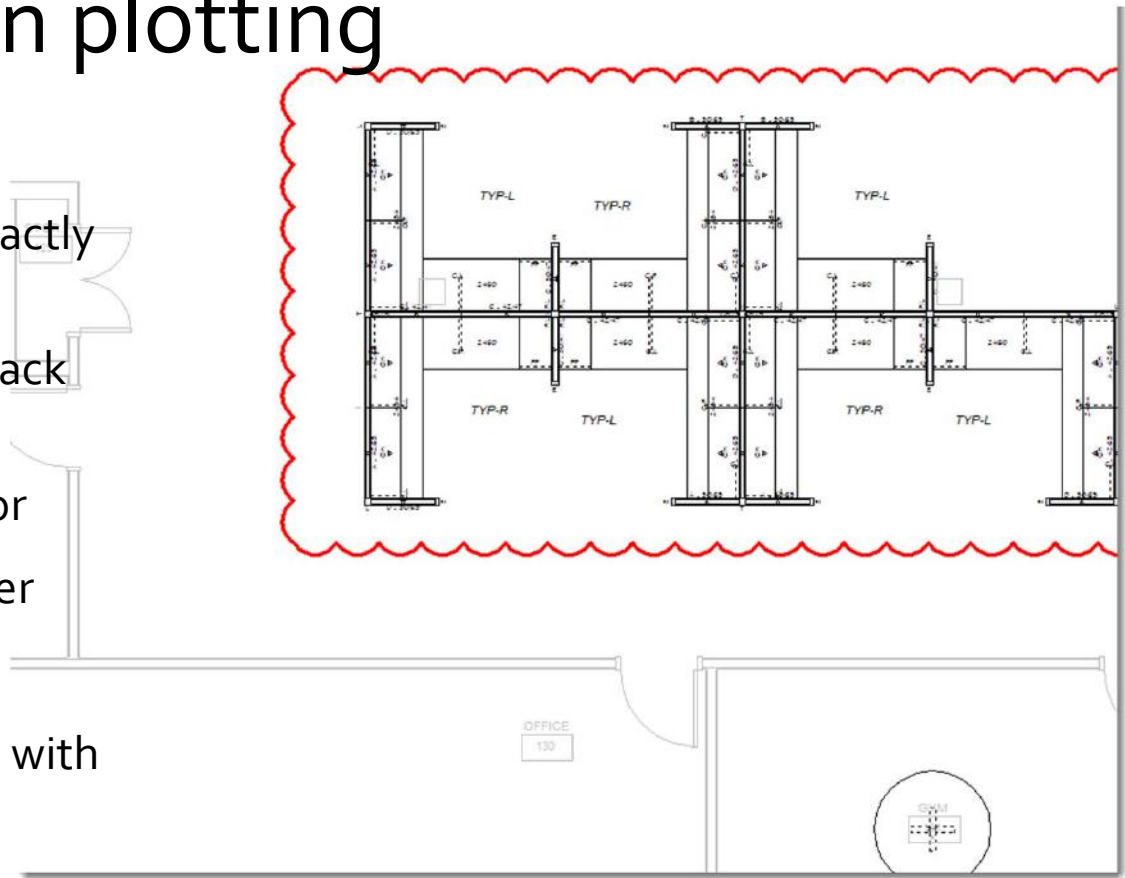

Workspace and custom tools

- Turn off extension when not using them
- Clean Demo mode
- Clean working mode with Custom Tools
- Custom Tools (Keybinding: C)
 - Circular replicate
 - Custom Shape Tools
 - Furniture tabs

Graphical Snapping

- Turn off On Curve
- Add a shortcut as a Key Binding

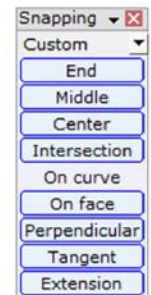
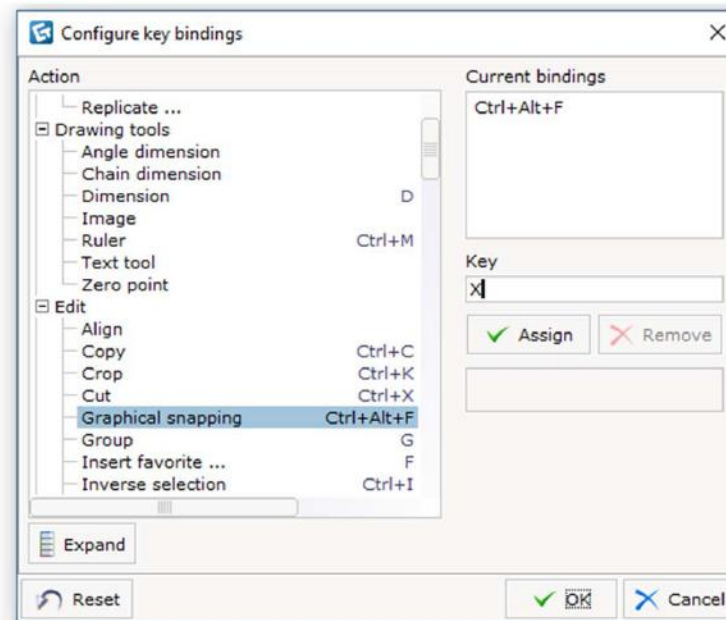

What to do when things go south

- F5
- Wiggle it
- Close and open the drawing
- Close and open CET Designer
- Clean start - Reboot
- Contact support

Fun Bonus Tips

- Right Click
- Task light
- Edit Graphics on Sketchup symbols



Thank you

Cate Sword
Cate Sword Consulting + Design

www.catesword.com

cate@catesword.com
616.662.cate

